

LWD-K VERSION - 3400 RPM

| POS. ITEM | CODICE PART No. | KIT KIT | DESCRIZIONE DESCRIPTION | Q.tà Qty. | MODELLI MODELS |
|-----------|-----------------|---------|------------------------------|-----------|--|
| 82 | 0009.0206.00 | E-F | BACK-UP RING | 1 | |
| 83 | 0009.0207.00 | E | SEAT | 1 | |
| 84 | 1802.0181.00 | E | SPRING | 1 | 2010 E - 2010 G 2015 E - 2015 G 3010 E - 3010 G 3015 E - 3015 G |
| | 1802.0182.00 | E | SPRING | 1 | 2020 E - 2020 G 3020 E - 3020 G 3025 G - 3522 G 4020 G |
| 86 | 0204.0043.00 | E | ADJUSTABLE KNOB | 1 | 2010 E - 2010 G 2015 E - 2015 G 3010 E - 3010 G 3015 E - 3015 G |
| | 0204.0046.00 | E | ADJUSTABLE KNOB | 1 | 2020 E - 2020 G 3020 E - 3020 G 3025 G - 3522 G 4020 G |
| 87 | 1215.0213.00 | | PRESS. VALVE KIT 1885 p.s.i. | 1 | 2010 E - 2010 G 2015 E - 2015 G 3010 E - 3010 G 3015 E - 3015 G |
| | 1215.0218.00 | | PRESS. VALVE KIT 2610 p.s.i. | 1 | 2020 E - 2020 G 3020 E - 3020 G 3025 G - 3522 G 4020 G |
| 88 | 1817.0045.00 | | HANDLE | 1 | |
| 89 | 1802.0180.00 | | SPRING | 1 | |
| 90 | 3003.0026.00 | | BALL | 1 | |
| 91 | 2812.0067.00 | | WASHER | 1 | |
| 92 | 2803.0373.00 | | NIPPLE | 1 | |
| 93 | 1210.0401.00 | | O-RING | 1 | |
| 94 | 1210.0399.00 | | O-RING | 1 | |
| 95 | 2801.0060.00 | | HOSE BARB FITTING | 1 | |
| 96 | 1210.0400.00 | | O-RING | 1 | |
| 97 | 0015.0171.00 | | ROD | 1 | |
| 98 | 1817.0046.00 | | CHEMICAL KNOB | 1 | |
| 99 | 3301.0543.00 | | ADJUSTABLE INJECTOR KIT | 1 | |
| 100 | 3622.0030.00 | E | STOP ADJUSTABLE NUT M4X4 | 1 | |
| 101 | 1227.0022.00 | E | NUT | 1 | |

E version

| POS. ITEM | CODICE PART No. | KIT KIT | DESCRIZIONE DESCRIPTION | Q.tà Qty. | MODELLI MODELS |
|-----------|-----------------|---------|--------------------------|-----------|---------------------------|
| 52 | 3609.0032.00 | | SCREW M6X20 | 4 | |
| 53 | 3016.0016.00 | | FLANGE | 1 | |
| 54 | 3607.0200.00 | | SCREW 3/8"16X3/4" | 4 | |
| 55 | 0019.0075.00 | D | OIL SEAL 35X62X 7 mm | 1 | |
| 56 | 3019.0004.00 | | SNAP RING C72 | 1 | |
| 57 | 3020.0012.00 | | SNAP RING C72 | 1 | |
| 58 | 2812.0064.00 | | WASHER | 1 | |
| 59 | 0438.0015.00 | | BALL BEARING 35X62X14 mm | 1 | |
| 60 | 0001.0336.00 | | CRANKSHAFT 5/8" | 1 | 2010 E - 2015 E 2020 E |
| | 0001.0337.00 | | CRANKSHAFT 5/8" | 1 | 3010 E - 3015 E 3020 E |

G version

| POS. ITEM | CODICE PART No. | KIT KIT | DESCRIZIONE DESCRIPTION | Q.tà Qty. | MODELLI MODELS |
|-----------|-----------------|---------|--------------------------|-----------|---|
| 40 | 3609.0032.00 | | SCREW M6X20 | 4 | |
| 41 | 3016.0012.00 | | FLANGE | 1 | |
| 42 | 3607.0199.00 | | SCREW 5/16"24X3/4" | 4 | |
| 43 | 0019.0075.00 | D | OIL SEAL 35X62X 7 mm | 1 | |
| 44 | 3019.0004.00 | | SNAP RING C72 | 1 | |
| 45 | 3020.0012.00 | | SNAP RING C72 | 1 | |
| 102 | 2812.0064.00 | | WASHER | 1 | |
| 103 | 0438.0015.00 | | BALL BEARING 35X62X14 mm | 1 | 2010 G - 2015 G 2020 G - 2520 G 3010 G - 3015 G 3020 G |
| | 0438.0070.00 | | BALL BEARING 35X62X14 mm | 1 | 3025 G - 3522 G 4020 G |
| 104 | 0001.0334.00 | | CRANKSHAFT 3/4" | 1 | 2010 G - 2015 G 2020 G |
| | 0001.0335.00 | | CRANKSHAFT 3/4" | 1 | 3010 G - 3015 G 3020 G - 3025 G |
| | 0001.0383.00 | | CRANKSHAFT 3/4" | 1 | 3522 G |
| | 0001.0384.00 | | CRANKSHAFT 3/4" | 1 | 4020 G |
| | 0001.0406.00 | | CRANKSHAFT 3/4" | 1 | 2520 G |
| | | | | | |

KIT VALVOLA ASP.-MAND. COMPLETE VALVE KIT 5025.0011.00

KIT A

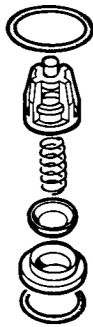

5025.0011.00

| POS. ITEM | CODICE PART No. | Q.tà Qty. |
|-----------|-----------------|-----------|
| 4 | 1210.0046.00 | 6 |
| 5 | 3009.0087.00 | 6 |
| 6 | 3604.0017.00 | 6 |
| 7 | 1802.0177.00 | 6 |
| 8 | 1205.0025.00 | 6 |
| 9 | 1210.0048.00 | 6 |

KIT GUARNIZIONI PISTONE / PISTON SEAL KIT Ø 15 mm 5019.0035.00

KIT B

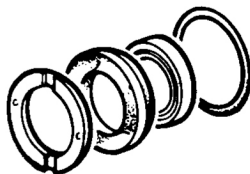

5019.0035.00

| POS. ITEM | CODICE PART No. | Q.tà Qty. |
|-----------|-----------------|-----------|
| 20 | 0009.0196.00 | 3 |
| 21 | 1241.0034.00 | 3 |
| 22 | 1241.0030.00 | 3 |
| 24 | 1210.0223.00 | 3 |

KIT PISTONE / PISTON KIT Ø 15 mm 2409.0071.00

KIT C

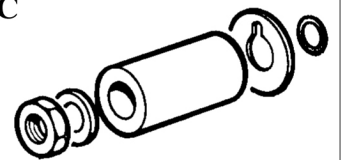

2409.0071.00

| POS. ITEM | CODICE PART No. | Q.tà Qty. |
|-----------|-----------------|-----------|
| 26 | 0600.0048.00 | 3 |
| 27 | 2811.0080.00 | 3 |
| 28 | 0202.0020.00 | 3 |
| 29 | 2812.0038.00 | 3 |
| 30 | 1210.0055.00 | 3 |

KIT GUARNIZIONI POMPA / SEAL KIT ALBERO FEMMINA / HOLLOW SHAFT 5019.0041.00

KIT D

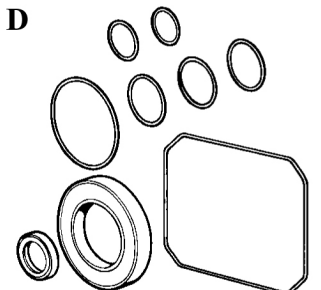

5019.0041.00

| POS. ITEM | CODICE PART No. | Q.tà Qty. |
|-----------|-----------------|-----------|
| 4 | 1210.0046.00 | 6 |
| 9 | 1210.0048.00 | 6 |
| 14 | 1210.0386.00 | 1 |
| 24 | 1210.0223.00 | 3 |
| 25 | 0019.0095.00 | 3 |
| 30 | 1210.0055.00 | 3 |
| 36 | 1210.0333.00 | 1 |
| 37 | 1210.0206.00 | 1 |
| 46 | 1210.0441.00 | 1 |
| 43-55 | 0019.0075.00 | 1 |